

Opening Doors

A guide to

S Christ-centered
Service &
G spiritual
Growth

TABLE OF CONTENTS

<u>Foreword</u>	<u>2</u>
<u>Mission Statement & Pastoral Challenge</u>	<u>3</u>
<u>What ministry is right for me?</u>	<u>5</u>
<u>Worship & Music</u>	<u>7</u>
<u>Children & Youth</u>	<u>11</u>
<u>Education & Discipleship</u>	<u>14</u>
<u>Mission & Service</u>	<u>17</u>
<u>Care Ministries</u>	<u>21</u>
<u>Bethel Lutheran School</u>	<u>24</u>
<u>Congregational Life</u>	<u>26</u>
<u>Finance & Stewardship</u>	<u>30</u>
<u>Technical & Administrative Ministries</u>	<u>32</u>
<u>Building & Grounds</u>	<u>34</u>
<u>Church Council</u>	<u>36</u>
<u>Current Pastoral Challenges</u>	<u>38</u>
<u>Campus Map</u>	<u>43</u>

FOREWORD

This ministry guide is designed to serve as a companion to Bethel's new 2011 pictorial directory. Together, both documents are intended to facilitate fellowship and ministry within the Bethel community and beyond – the directory by providing photos, names, and contact information and this “Opening Doors” ministry guide by introducing you to the amazing ministries led by members of the Bethel community. The specific purpose of this guide is to link participants to ministry opportunities.

Did you know that there are over 70 different ministry opportunities made available to you at Bethel? It takes all sorts of people and all kinds of talents to share God's Good News. There is room for everyone ... and there is always room for one more person, for one more opinion, one more faith perspective, once more voice, and one more pair of hands! This person could be you! This opinion, faith perspective, voice, or hand could be YOURS!

We invite you to peruse this ministry guide and to freely utilize the information provided in it. All of the ministries at Bethel are open for new participants; some of them (those for children and youth) may require you, though, to follow Bethel's Child Protection Policy.

Wishing you Christ's blessings in your life and shared ministry,

Molly Schrey

Ministry Liaison
Church Council Member

Patricia Myerholtz

Adult Ministry Coordinator
Bethel Staff

MISSION STATEMENT

The mission of Bethel Lutheran Church is

- To prayerfully **invite & welcome** people into a relationship with God,
- to **grow & equip** one another as devoted followers of Jesus Christ, and
- to **care for & serve** others empowered by the Holy Spirit.

2011 PASTORAL CHALLENGE

Since the mid-1990s, significant changes have taken place in the South Bay communities. Orchards have given way to large office complexes and high rise buildings. Growing numbers of mostly Asian and Indian immigrants have moved here to find employment in the high-tech sector. With the changing face of our surrounding communities, Bethel's membership (as that of many other Lutheran congregations) has begun to decline while the congregation has found it difficult to understand and embrace the very different cultural and religious identities and practices of its new neighbors.

Today, the South Bay and particularly Silicon Valley is a very diverse multi-cultural community. The Christian churches, and Lutherans in particular, face several significant challenges. How the church responds under God's guidance, will determine the future of the church (and Bethel) in this region for coming generations.

If Bethel is to thrive in the future it cannot be a respite for like-minded people of northern European descent. Bethel cannot continue to effectively serve this community in the name of Jesus with methods and approaches that worked when immigration was from the mid-west and most of the community was assumed to be Christian. Everything has changed and Bethel needs to change as well if it is to remain a vital community of faith that continues to make a difference in the name of Jesus Christ in this community.

The Challenge: *“That Bethel Lutheran Church and School refocus every aspect of its ministry and work to reach out and more effectively serve the multi-cultural community in which it is located in the name of Jesus Christ.”*

The Focus: *“To redirect Bethel’s primary focus in all aspects of our work and ministry toward those who are not here!”*

The Tools: Using the “Up, Out, and In” of our present Mission Statement, structure all aspects of our ministry to use this triadic formula to develop and measure our progress toward becoming a multi-cultural congregation.

- **“UP”** - Our Mission is to **GROW & EQUIP** one another as devoted followers of Jesus Christ.
- **“OUT”** - Our Mission is to **CARE FOR & SERVE** others through the power of the Holy Spirit.
- **“IN”** - Our Mission is to **INVITE & WELCOME** people into a relationship with God through Jesus.

WHAT MINISTRY IS RIGHT FOR ME?

How Can We Discern Our Calling in Ministry?

As Christians we are stewards of the resources God gives us for serving all people. Our vocations^{*)} are one avenue for doing God's work in the world.

Stewardship is the cultivation of resources for God. The Bible tells us that one of the most important resources God has given us is our gifts, aptitudes, talents, and abilities.

In the process of discerning your own individual ministry, please remember three important insights of Martin Luther's theology:

- **All forms of work are participation in God's work.**
- **All forms of work are ways of serving others.**
- **All forms of work are based on God's gifting.**

So how does this work out for Christian believers? First, a Christian has to consider both of these questions: What has God called and equipped me for as my work/career? And how is God calling me to serve in and through the church?

In some rare cases, a person's church ministry becomes one's full-time career as well. Then the answers to the two questions coincide. In most cases, however, Christians must answer each question separately. Sometimes what you do in your "secular" calling is very similar to what you do inside the church. You may be a teacher or strategic planner or artist outside the church and use those same abilities inside. In other cases, you may find God calling you to do an almost completely different sort of work in the church than you do out in the world. The banker might be a wonderful Sunday school teacher for children.

Nevertheless, we affirm a three-part method for discerning a call, whether to secular work or church work or anything else. To discern a ministry call, consult three factors: Affinity, Ability, and Opportunity.

AFFINITY – What "people's needs" do I resonate with?

Do not start with yourself. Don't start with an abstract inventory of your gifts and skills to discern your aptitudes. Aptitude tests are based on past experience and self-knowledge, and our self-knowledge is limited.

^{*)} *Vocation* - "Where God's passion and the individual's passion intersect."

Rather, look at concrete needs in the community (context) around you. What needs do you tend to care about? What problems or kinds of people or ministry needs move you? It is important that we get into ministry with a passion for a certain cause or unmet need.

Subsequently, gifts might “pop out” and surprise us as we participate in a great variety of ministries.

ABILITY – What are my abilities and deficiencies?

It is important to look at your abilities. Many people become burdened to see a ministry begin, but they are not realistic about their own abilities and limitations. For example, they themselves want to be leaders even though they do not have the gift of organizing and galvanizing people to follow them. Instead, ask yourself, “What should I be doing, and what should I let someone else to be doing?”

OPPORTUNITY – Where does the community tell me I am needed?

When we become Christians, we become “members of one another” (Eph. 4:25). We cannot understand ourselves fully without paying attention to what our brothers and sisters can see. There may be opportunities for us to serve that we have never considered, but for which we are perfect.

Summary

Your vocation is a part of God’s work in the world, and God gives you resources for serving the human community. These factors can help you identify your calling.

Affinity—“Look out.”

Affinity is the normal, existential way to discern call. What people needs do I vibrate to?

Ability—“Look in.”

Ability is the normal, rational way to discern call. What am I good at doing?

Opportunity—“Look up.”

Opportunity is the normal, organizational way to discern call. What do the ministry leaders and my friends believe is the most strategic kingdom need?

Your life is not a series of random events. Your family background, education, and life experiences—even the most painful ones—all equip you to do some work that no one else can do. “We are what God has made us, created in Christ Jesus for good works, which God prepared beforehand to be our way of life“ (Eph. 2:10).

*These three pages are an abridged version of an article written by Rev. Timothy Keller.
Copyright © 2007 by Timothy Keller, © 2011 by Redeemer City to City.*

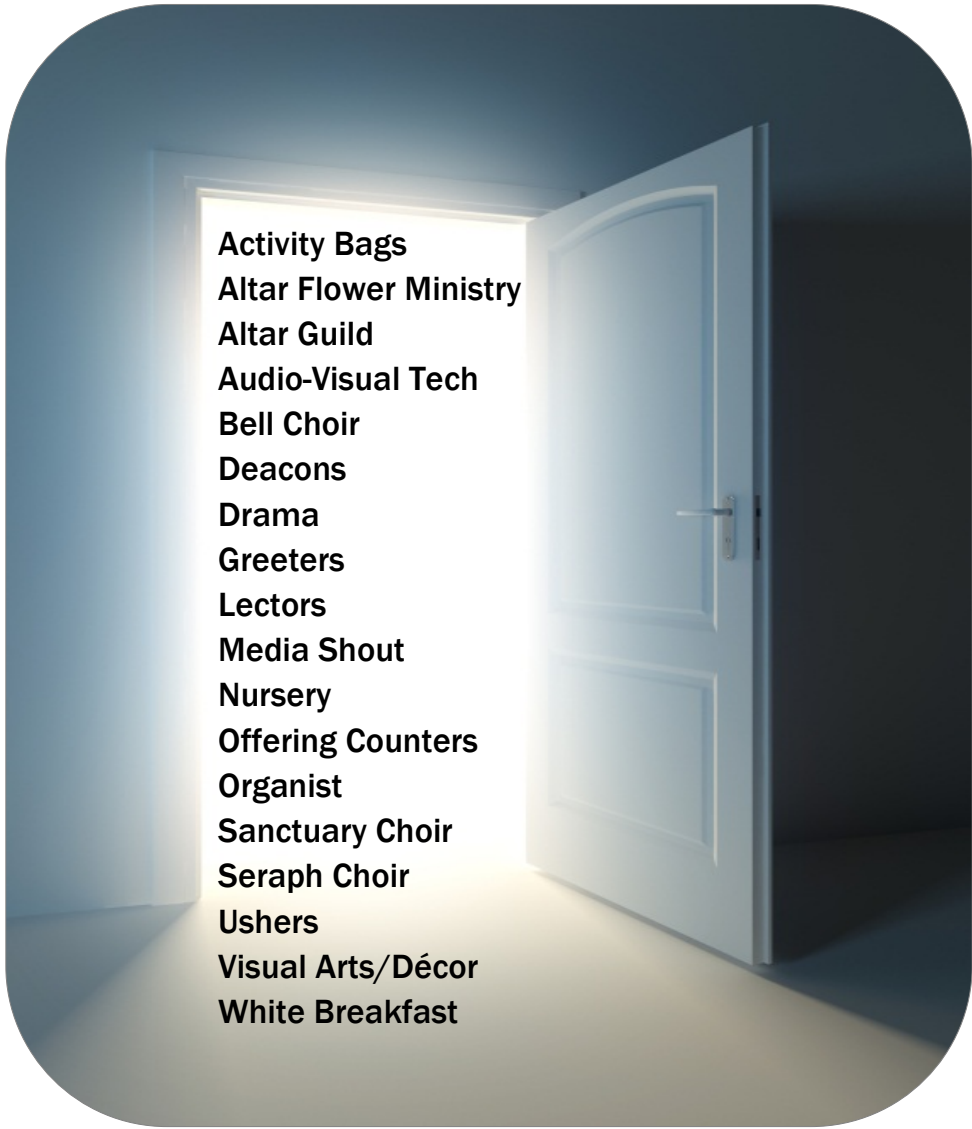

Worship & Music

MINISTRY LEADS

[Tom McAvoy](#)

[Brian Schuette](#)

Activity Bags

[Karen Fox](#)

Activity bags are provided for our younger children during worship. Volunteers replenish the bags with new activity worksheets for the upcoming service and also maintain the colored pencil sets. The commitment is approximately once every ten weeks and takes less than an hour to complete. A brief training is provided.

Altar Flower Ministry

[Karen Fox](#)

Coordinates the donation of altar flowers and ensures that thanksgiving or memorial dedications are published in the Sunday bulletins.

Altar Guild

[Lois Eid](#)

[Claire Bollesen](#)

The Altar Guild prepares the altar for worship and Holy Communion, an essential part of worship preparation. The types of tasks included are: setting-up and cleaning the silver service communion, maintaining the altar linens, purchase wine and grape, changing paraments when needed, checking candles, and stripping the altar on Maundy Thursday.

Audio-Visual Tech

[Tom Hoegel](#)

The Audio/Visual Team supports Sunday worship and all of Bethel's events with technology that enhances them through creative uses of sound and video. Volunteers are needed to run the sound and video systems when needed, as well as possibly helping with video projects as they come along. Learn how to run Media Shout (the software used for projecting worship content on the screens in the Sanctuary). After an initial training period and a period of "shadowing" experienced operators, volunteers can sign up for either worship service.

Bell Choir

[Chris Hogan](#)

The hand bell choir performs about once a month at services; the choir meets for rehearsals on Sundays from 7:00-9:00 pm in the [music room](#).

Deacons

[Mark Evashenk](#)

The Deacons of the Congregation are members of Bethel who assist the pastors in the worship service, in serving communion, and helping others in prayer. Training provided.

Drama

[Charlie Schrey](#)

[Molly Schrey](#)

Looking for actors, writers, directors, producers, and tech support to provide topical live drama and/or videos to support worship lessons and sermons.

Greeters

[Ed Fox](#)

Sunday greeting, or “hosting”, at Bethel involves a commitment to be in the [narthex](#) before and after the worship service; usually about four or five Sundays a year. Your purpose is to seek out and greet people you do not already know and, if they are “new” to Bethel, make every effort to assist them in having a memorable worship experience while they are at Bethel that day.

Lectors

[Mark Evashenk](#) *It is a great privilege to read God’s Word at a worship service! We are grateful for the many volunteers that have taken that assignment and so enhanced worship at Bethel. God’s Word holds the most important place at our public worship together with Holy Communion. You may sign up to lector at either service.*

Media Shout

[Elise Holst](#)

Organizes media in cooperation with the pastors to be used for services.

Nursery

[Amanda Boniface](#)

Volunteers who help run [nursery](#) during services and when needed.

Offering Counters

[Liz Tribby](#)

Sunday morning offerings are counted by two-member teams who record information on who gave how much to what fund, prepare the deposit, and take it to the bank. Each team counts one service on one Sunday a month.

Organist

[Melody Bast](#)

Plays organ for services.

Sanctuary Choir

[David Herberg](#)

Singers rehearse on Thursday evenings from 7:30-9:00 pm in the [sanctuary](#) and sing two or three times per month as scheduled. All singers, experienced or not, are welcome to join!

Seraph Choir

[Barbara Larsen](#)

The Seraph Choir is for children, grades 2 through 6, who sing during some services. The choir meets Thursday afternoons during the school year in the [music room](#).

Ushers

[Ed Fox](#)

Ushers are part of a system of greeters who are responsible for extending the hospitality of the congregation. The commitment is open-ended, much like singing in the choir. All that is needed is regular worship attendance and a willing person. No meetings are held, however a brief training is provided. Sure, there are tasks to be done, like handing out bulletins and passing around the offering plates. However, the most rewarding part of the job is making people feel at home on Sunday mornings. More ushers are always welcome.

Visual Arts/Décor

[Doreen Baldwin](#)

The Visual Arts and Décor team design, create and install visual displays relating to liturgical seasons. This group welcomes those with a visually creative-side to their spirituality.

White Breakfast

[Eleanor Incerpi](#)

Communion/breakfast served during Maundy Thursday in Torvend Hall from 9:30am to 12pm. The new command (Latin “mandatum novum,” Maundy) given by Jesus that his disciples should love one another during the Last Supper sets the tone for this breakfast. Look for sign-ups in the weeks before Easter. Space limited.

Worship Team

[Tom Hoegel](#)

The Bethel Worship Team welcomes more musicians to share their gifts in worship- singers or instrumentalists including guitar, drums, bass, piano, brass, woodwinds and strings. Bethel has a fantastic music program and welcomes interested musicians!



Children & Youth

CHILDREN'S MINISTRY LEAD

Available

First Communion

[Pastor Gabriele Schroeder](#)

Provides teaching for children and their families on the meaning and significance of Holy Communion and its place in the spiritual life of families. Offered in the fall as needed.

Kid Connection

[Amanda Boniface](#)

Sunday school for age 3 through 6th grade. Meets in [Torvend Hall](#) at 9:15am.

Vacation Bible School (VBS)

[Amanda Boniface](#)

Vacation Bible School for age 3 through 6th grade. Week-long adventure full of Bible stories, crafts, games, snacks, and more during the summer.

YOUTH MINISTRY LEADS

[Tom Hoegel](#) (Bethel Youth Director)

[Marianne Nadell](#)

Wildside (6th-8th grade)

[Carol Wheaton](#)

[Jeanine Woodell](#)

Fun, Faith, and Fellowship events for 6th, 7th and 8th graders include a fall retreat, winter ski trip, Rock and Water, and other events throughout the year.

7th-8th Grade Confirmation

[Robyn Winegardner](#)

[Pastor Gabriele Schroeder](#)

Confirmation is designed to be inviting and have a friendly, fun, challenging and exciting atmosphere. This evening program shatters the "church is boring" stereotype and helps teenagers celebrate God's presence in their lives. It is filled with laughter, antics, videos, singing, dramas, a message and small groups that will challenge middle school students toward spiritual maturity. Wednesday nights from September to May, 6:15-8:15pm.

9th Grade Confirmation/Affirmation of Baptism

[Susan Leavitt](#)

[Pastor Gabriele Schroeder](#)

Affirmation of Baptism is the last year of Confirmation studies. It builds upon what the students have learned during their first two years and helps them discover more ways in which to seek God and to affirm their faith. During AoB, students create a Faith Statement that is shared on Confirmation Sunday with the congregation. AoB classes typically meet on Sundays from 9:15-10:30am.

Common Ground

[Tom Hoegel](#)

Common Ground is a dynamic Sr. High music and drama traveling ministry at Bethel that has been going strong for close to 30 years. It involves about 35 high school students meeting once a week from February to June, and then we take a 10-day tour of the western United States (by bus) presenting a Christ-centered message of hope through original dramas, cutting-edge music, a breathtaking youth band, bold sharing of personal experiences, and infectious joy. This is also a great opportunity for adults who are interested in being youth sponsors.

Mission to Mexico

[Tom Hoegel](#)

Each spring break, a group of youth travel to Tijuana, Mexico to join forces with [Esperanza International](#), or “Hope”, an organization that works to build houses, schools and centers for the local community. We work side by side with low-income families and the Esperanza staff-mixing concrete, pouring tiles and beams, digging trenches, and a host of other challenging work. In the process, families learn the building process, which helps make their community more self-sufficient, and Bethel volunteers practice their Spanish, and touch the lives of our neighbors south of the border. These three days of work, laughter, growth and fun lead to changed lives on both sides of the border.

Senior High Fellowship

[Tom Hoegel](#)

Just about every Wednesday night during the school year, the high school youth meet up for a mixture of topical discussion, fellowship, food, and fun. Each week is something new. Sign up on the [youth website](#) to get weekly notices about upcoming events.



Adult Education

Library Team

Men's Night Out

The Network (Young Adults)

Martha Bible Study

Priscilla Bible Study

**Saturday Women's
Bible Study**

Women of Wednesday

Women's Retreat

Education & Discipleship

MINISTRY LEAD

[Dave Denny](#)

Adult Education

[Dave Denny](#)

Works with the pastors in engaging the congregation in adult education.

Library Team

[Margaret Lund](#)

The Library Committee meets every Wednesday from 9:30am to 12:00pm. Books, videos, DVD's, sermon tapes and other media are prepared on a weekly basis for circulation, and a yearly used book sale is held in the Spring. Not only is our [library](#) is a wonderful resource for teachers and students of all sages, our collection includes everything from the works of Luther to Christian romances. Want to help?

The Network (Young Adults)

[Jillian Cosgrove](#)

[Lexi Baker](#)

For young adults (ages 18 through 35) who gather a couple of times a month for fellowship, bible study, community service and more. Check out the [Network website](#).

Men's Night Out

[Steve French](#)

This group invites all men to learn more about God's relevance in their lives and to give each other support. The group meets once a month on Mondays from 7:30-9:00pm in the [Fireside Room](#).

Martha Bible Study

[Charnel Wedgwood](#)

Women's Bible study group that meets the 2nd Monday of each month in the [Fireside Room](#) from 12:15-2:00pm. Bring a lunch.

Priscilla Bible Study

Delores Koser (Sunny View Retirement Community)

The Priscilla Bible Study group meets at [Sunny View Retirement Community](#) (Sunny View Lutheran Home) every 3rd Tuesday of the month 9:30-11:30am.

Saturday Women's Bible Study

[Natalie Rogerson](#)

The Saturday Women's Bible Study group meets on the 3rd Saturday of every month in the [library](#) from 9:30-10:30am.

Women of Wednesday (WOW)

[Kathryn Montano](#)

The Women of Wednesday meet every Wednesday from 10:00-11:30am in the [Fireside Room](#). Enjoy food, fellowship, prayer, and bible study.

Women's Retreat

[Norita Hoegel](#)

[Pastor Gabriele Schroeder](#)

Great opportunities in the spring and fall for women to connect with each other and spend time with God. There are always great activities and food. Look for sign-up sheets.



Adult Mission to Mexico
Advent Group Ministries
Altar Flower Delivery
Bread for the World
Crop Walk
Correctional Institutions Chaplaincy
First Immanuel Clothes Closet
Habitat for Humanity
Help One Child
LWR Fair Trade
Bethel School in Himo, Tanzania,
MaaSae Girls Lutheran Secondary School,
Mission to Tanzania
New Life Band
Mount Cross Lutheran Camp
Quilters
San Jose Family Shelter
Second Harvest Food Bank
Service Worship
Sunnyview Auxiliary
Sunnyvale Fish
Tanzania AIDS Orphans
The Lord's Pantry
West Valley Community Services

Mission & Service

The following list of outreach & service ministries contains information on both

- **outside organizations** that we actively support either by providing funds for their work or through our hands-on support and
- outreach & service ministry done **within the Bethel community** itself.

For outside organization, a Bethel contact and web address are provided, for Bethel's ministries the name(s) and contact information of ministry leaders as well as a description are provided.

MINISTRY LEADS

[Lois Brouillette](#)

[Dale Jones](#)

Adult Mission to Mexico

[Tom Hoegel](#)

www.esperanza.org

Advent Group Ministries

[Dale Jones](#)

www.adventgm.com

Altar Flower Delivery

[Karen Fox](#)

[Patricia Myerholtz](#)

Delivery of altar flowers to those in need on Sunday.

Bread for the World

[Jackie Jones](#)

www.bread.org

Crop Walk

[Lois Brouillette](#)

www.churchworldservice.org

Correctional Institutions Chaplaincy

[Deirdre Lum](#)

www.cicministries.org

First Immanuel Clothes Closet

[Lois Brouillette](#)

www.firstimmanuel.org

Habitat for Humanity

[Dale Jones](#)

www.habitat.org

Help One Child

[Jackie Jones](#)

www.helponechild.org

Lutheran World Relief (LWR) Fair Trade

[Lois Brouillette](#)

www.lwr.org/fairtrade

Bethel School in Himo, Tanzania,

[Lois Brouillette](#)

Bethel School in Himo, Tanzania, was started by Pastor Godbless Mamkwe and his wife, Neema, to serve the AIDS orphans in their area. The school has both a preschool and primary school. 70% of the 200 students are AIDS orphans on scholarship.

MaaSae Girls Lutheran Secondary School (MGLSS)

[Lois Brouillette](#)

[The MaaSae Girls Lutheran Secondary School](#) (MGLSS) is a residential high school (Forms 1-6) for young women from pastoral tribes, such as Maasai, located in Monduli, Tanzania. Funding and scholarships for the school are administered by Operation Bootstrap Africa.

Mission to Tanzania

[Lois Brouillette](#)

From time to time, members of Bethel have organized trips to aid with mission work in Tanzania.

New Life Band

[Lois Brouillette](#)

[The New Life Band](#) serves the youth of Tanzania through youth camps, school visits, conferences and concerts, and also through their new secondary school and vocational training Center in Arusha, Tanzania.

Mount Cross Lutheran Camp

[Holly Lofgren](#)

www.mtcross.org

Quilters

[Anna Hoegel](#)

[Ordetta Hovland](#)

The Bethel quilters create and send hundreds of quilts locally and all over the world all year. Meets every Monday from 9:15am to 12 pm in the [Fireside Room](#).

San Jose Family Shelter (Family Supportive Housing)

[Deirdre Lum](#)

www.sjfamilyshelter.org

Second Harvest Food Bank

[Jackie Jones](#)

www.shfb.org

Service Worship

[Jackie Jones](#)

Throughout the year, there are opportunities where worship will be in service to others and the community. On these Sundays, we begin with an abbreviated worship service at 9:00am and then go forth in service for the day. Watch for dates for this important ministry.

Sunnyview Auxiliary

[Eleanor Incerpi](#)

www.sunny-view.org

Sunnyvale Fish

[Lois Brouillette](#)

www.sunnyvalefish.org

The Lord's Pantry (see Second Harvest Food Bank)

[Lois Brouillette](#)

www.shfb.org

West Valley Community Services

[Dale Jones](#)

www.wvcommunityservices.org



Altar Flower Delivery

Membership Data

New Member Reception

Prayer Chain

Stephen Ministry

Hospitality

Sunshine Team

Visitor Follow-Up

Care Ministries

MINISTRY LEAD

Available

Altar Flower Delivery

[Patricia Meyerholtz](#)

Altar flower delivery's Sunday afternoon volunteer arranges Bethel's altar arrangement into three to five smaller bouquets. The recipients list is provided by [Pastor Ken Bancroft](#) and left in the [Sacristy](#). Volunteers not only deliver beautiful flowers and the worship bulletin, but most importantly, caring conversation and an ongoing link to our Bethel community.

Membership Data

[Liz Tribby](#)

Using the congregation's Shepherd's Staff database to keep and update members records.

New Member Reception

[Pastor Randy Pabst](#)

Provides new member classes as needed.

Prayer Chain

[Pastor Ken](#)

[Pastor Randy](#)

[Pastor Gabi](#)

Contact any of the pastors to initiate a prayer chain.

Stephen Ministry

[Pastor Ken](#)

Meets every 1st and 3rd Tuesday. of the month in the [Fireside Room](#) from 7:00-9:30pm. A caring ministry that is available for all who feel the need for extra support during trials of life. Training sessions are provided as needed for those who would like to become Stephen Ministers.

Hospitality & Welcome

[Patricia Myerholtz](#)

Volunteers who welcome worship visitors and make them feel welcome at Bethel.

Sunshine Team

[Gail Backo](#)

[Patricia Myerholtz](#)

The Sunshine Team volunteers who work closely with the pastors in sending of cards to encourage, welcome, and celebrate. Weekly.

Visitor Follow-Up

[Patricia Myerholtz](#)

The visitor follow-up ministry sends out welcome cards and information to current visitors.



Bethel Lutheran School

MINISTRY LEADS

[Marion Abney](#)

[Joan Christensen](#)

BLS/Church Workdays

[Tom Hoegel](#)

Meets every couple of months to help maintain the church and school grounds.

Bethel Lutheran School Volunteers

Open

Organizes volunteers to help with needs for the school with special events, reading to kids, etc.



Evergreens
Fun with Faith
The Network (Young Adults)
Out and About Adventures
Readers Anonymous
Sunday at the Movies
Supper Club
Art Fair
4th of July Celebration
Labor Day Retreat
Ministry Fair
Memorial Services
Special Events/Helping Hands
Sunday Coffee Hosts
Weddings

Congregational Life

MINISTRY LEADS

[Patrice Sera](#)

[Sharon Parady](#)

ONGOING EVENTS

Evergreens (55+)

[Pastor Randy](#)

The group meets every 4th Thursday of the month from 10:30am to 12:00 noon.. Fellowship, food, adult education on life after 55 and Bible studies. [Fireside room](#).

Fun with Faith

[Kathy Arnold](#)

All ages meet every Wednesday night from 6:15-8:15pm for fellowship, a light dinner, bible studies, life skills classes, kids programs, art classes, and more (late September through mid-May). Begins in [Torvend Hall](#).

The Network (Young Adults)

[Jillian Cosgrove](#)

[Lexi Baker](#)

For young adults (ages 18 through 35) who gather a couple of times a month for fellowship, bible study, community service and more. Check out the [Network website](#).

Out and About Adventures

[Ed](#) and [Karen Fox](#)

Monthly outings for the congregation to enjoy using the Bethel bus. Recent events have included a trip to Monterey, wine tasting in Napa, museums, etc. Look for sign-up sheets in the church's [narthex/entry](#).

Readers Anonymous

[Kathy Arnold](#)

Readers Anonymous is a fun group that gets together once a month to discuss a great book they are reading. For more information on upcoming meetings, please check the Sunday church bulletin.

Sunday at the Movies

[Carol Olson](#)

The group meets on the 2nd Sunday of the month from 2:00-3:30pm. Fellowship opportunity to watch a fun movie together for all ages in the [Fireside Room](#).

Supper Club

[Laurie Bryson](#)

Small groups formed twice a year. These groups meet at each others' homes, restaurants, parks, etc. to enjoy fellowship and a meal with one another at least once a month.

FELLOWSHIP EVENTS

Art Fair

[Sue Jacobus](#)

An annual art fair sponsored by Bethel Lutheran Church and School in the Spring that showcases works of the congregation and school along with art activities for the whole family.

4th of July Celebration

[Patrice Sera](#)

[Sharon Parady](#)

Watch Cupertino's fireworks from Bethel's front lawn. Enjoy barbeque potluck (bring your own meat and dish to share) Streets close to traffic at 5:30pm. The event starts at 5:30 pm and ends around 10:30pm.

Labor Day Retreat

[Molly Schrey](#)

[Liz Barton](#)

Retreat at [Mt. Cross Lutheran Camp](#) during Labor Day Weekend. On the Sunday before Labor Day, Bethel's 10:30am worship is held at Mt. Cross. The retreat includes fun, prayer, fellowship, food, games, hikes, and more in the beautiful Santa Cruz Mountains (Felton).

Ministry Fair

[Molly Schrey](#)

[Patricia Myerholtz](#)

On one Sunday early on in the fall, all of Bethel's many ministries invite you to come and check out their work. Maybe there is something you did not know yet about your church? Maybe there is a new way that you may be serving God's church and your neighbors? Using a fun theme the ministries set up booths with food and information.

HOSPITALITY

Receptions Coordinator

Position available

Coordinates volunteers who help with receptions for weddings, memorial services, and special events.

Sunday Coffee Hosts

[Tony Stieber](#)

This is a groups of volunteers who help make coffee for the Sunday coffee cart in the [welcome zone](#). Please consider signing up for a Sunday morning twice a year (time commitment: about 3 hours).



Community

Time & Talent

Finance Committee

Audit Committee

Finance & Stewardship

MINISTRY LEADS

[Angela Brown](#)

[Chris Freckman](#)

Community

[Angela Brown](#)

Works closely with pastors on ways to communicate stewardship to the congregation.

Time & Talent

[Ann Marie Kenitzer](#)

[Patricia Myerholtz](#)

Communicates weekly opportunities for members to use their time and talent.

Finance Committee

[Dan Gaardsmoe](#)

The Finance Committee works closely with the pastors and Bethel's Parish Administrator to monitor the congregation's income and spending, to develop the budget for the coming year, and to help provide sufficient funds for the ministry of the congregation.

Audit Committee

[Kelly Johnson](#)

The Audit Committee undertakes the annual internal audit of the congregation's finances and makes recommendation on improving accounting practices.



Technical & Administrative

MINISTRY LEAD

[Hella Bluhm-Stieber](#)

Communications Team

[Hella Bluhm-Stieber](#)

[Vern Bollesen](#)

Works with church communication projects with everything from paper to web communication.

Web Master

[Dave Arnold](#)

Oversees development and upkeep of church website.

Technology Support

[Liz Tribby](#)

[Brad Martinson](#)

The technology support team oversees technology needs for the church and provides technology support as needed.

eNewsletter

[Elise Holst](#)

Gathers and distributes information for the weekly church e-news (church newsletter e-mailed to all who want it once a week) Contact Elise if you want to receive the e-news.

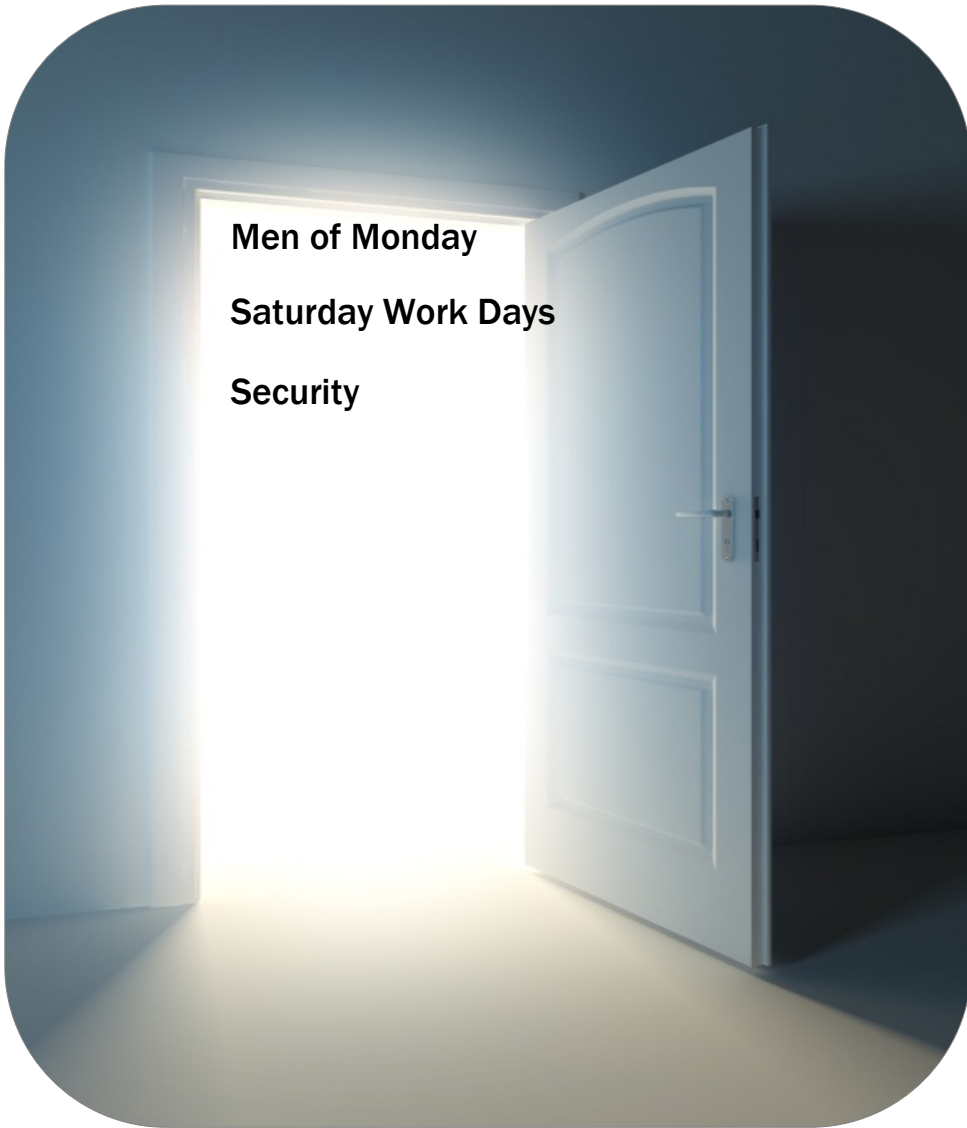

Buildings & Grounds

MINISTRY LEADS

[Tom Cole](#)

[August Colandrea](#)

Men of Monday

[Tom Cole](#)

A group of men who meet every Monday from 9am to 12pm to help maintain the church grounds. Meet in the [Fireside Room](#).

Saturday Work Days

[Tom Hoegel](#)

This is a great opportunity for volunteers of all kinds of skill levels to help with church grounds projects. Look for days on bulletin and website.

Security

[Steve Emmert](#)

This is a group of volunteers who commit one week to help secure the Bethel grounds at night.



Church Council

MINISTRY LEADS

[Mark Evashenk](#) (Council President)

[Rick Westwick](#) (President Elect:)

Fiscal Officer

[Dan Gaardsmoe](#)

Communications Officer

[Hella Bluhm-Stieber](#)

School Board Chair

[Joan Christensen](#)

Ministry Liaison

[Molly Schrey](#)

Human Resources Advisor

[Donna Kuester](#)

Project Manager Advisor

[Bill Weberg](#)

Member at Large

[Mary Thomas](#)

Member at Large

[Liz Barton](#)



Welcome Zone Committee

Multi-Ethnic Taskforce

**Community Information
Taskforce**

**Church/School Relations
Committee**

Current Challenges

LIVING OUR FAITH CAMPAIGN

MINISTRY LEADS

[Rick Westwick](#)

[Pastor Randy](#)

Welcome Zone Committee

Welcome Zone Projects

[Tom Hoegel](#)

Ministry of Welcome

[Patricia Myerholtz](#)

The purpose of the Welcome Zone Committee is revitalize the [welcome zone](#) both as a location AND as a concept of how we receive visitors and guests and welcome them to our campus for worship and the many other ministries of Bethel Church and School.

Church/School Committee

[Marion Abney](#)

[Mariane Nadell](#)

The purpose of the Church/School Committee is to strengthen the relationship between participants of Bethel Church with the families of Bethel School.

Community Information Task Force

[Donna Kuester](#)

The purpose of the Community Information Task Force is to out into the community and visit with local leaders (i.e. public school principals, community leaders, police and sheriff departments, etc.) and discover the needs, concerns, issues, problems, joys of this area.

Multi-Cultural/ Multi-Ethnic Task Force

[Sam Sudarsanam](#)

The purpose of the Multi-Cultural/ Multi-Ethnic Task Force is to plan for and oversee educational opportunities (speakers, classes, resources, etc. in order to gain a greater understanding of the diverse ethnic and cultural make-up of this area.

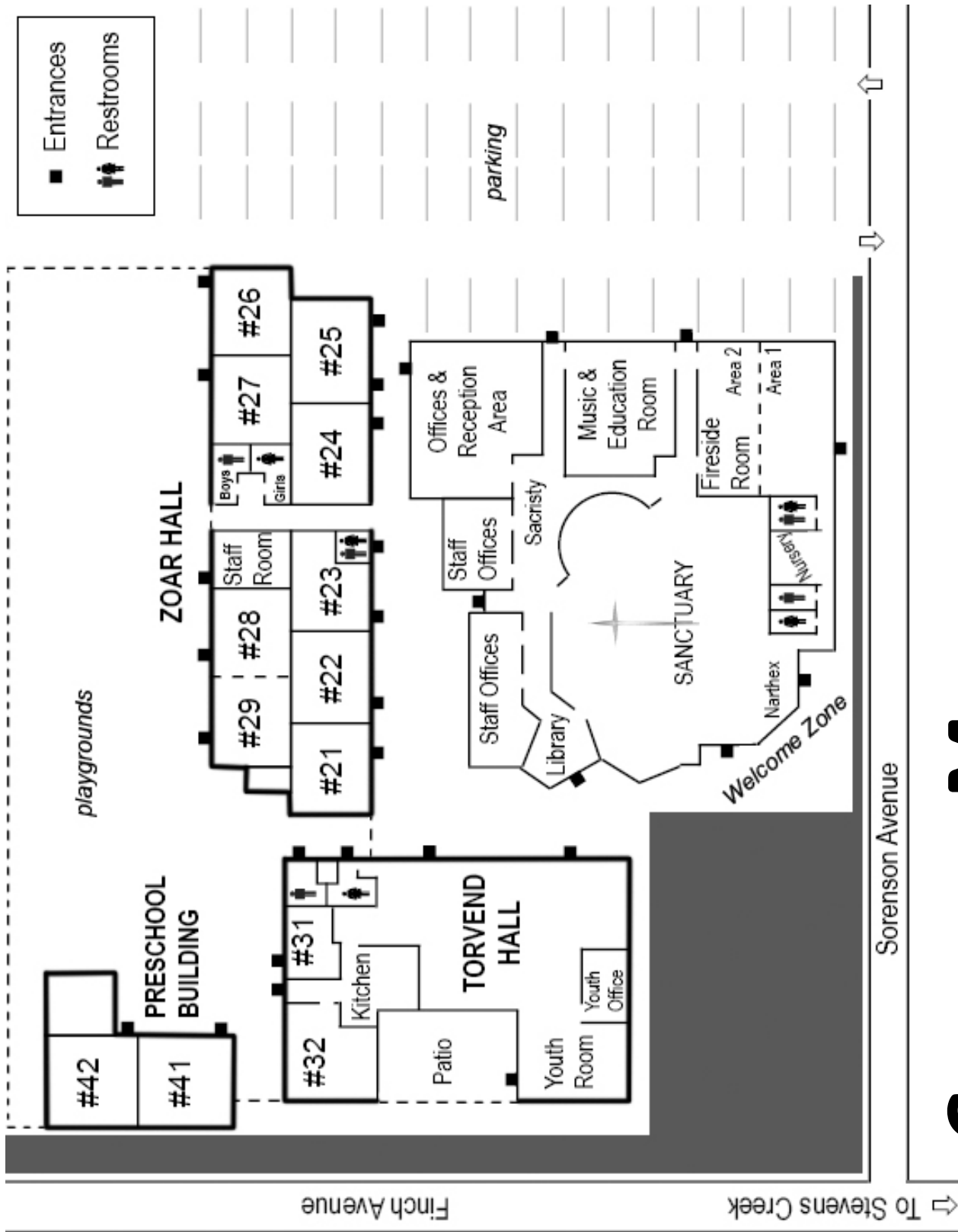

Campus Map



2011

Bethel Lutheran Church

10181 Finch Avenue | Cupertino, CA 95014
408 -252-8500 www.bethelcupertino.org